

Basic Troubleshooting

XL1002J

*LED not displayed

Check the power source is correct voltage and correct polarity.
Check the connection of signals cable

*Don't count step

Check the signal wire is correct and tight.
Check the impulse signal range

*Display appears scrambled

Check that all connections are correct and tight.
Check that there is no harsh interference nearby.

*Display appears scrambled

Check that all connections are correct and tight.
Confirm no strong electromagnetic interference nearby.

*Caution

Do not disassemble

Panel Cutout Size

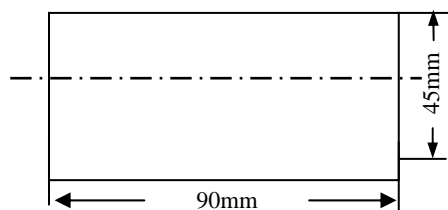

MANUAL
DIGITAL COUNTER CONTROLLER

Basic Troubleshooting

XL1002J

*LED not displayed

Check the power source is correct voltage and correct polarity.
Check the connection of signals cable

*Don't count step

Check the signal wire is correct and tight.
Check the impulse signal range

*Display appears scrambled

Check that all connections are correct and tight.
Check that there is no harsh interference nearby.

*Display appears scrambled

Check that all connections are correct and tight.
Confirm no strong electromagnetic interference nearby.

*Caution

Do not disassemble

Panel Cutout Size

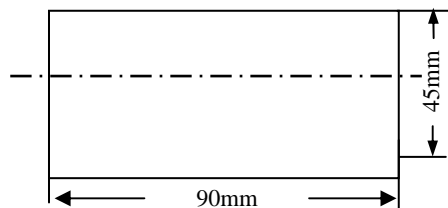

MANUAL
DIGITAL COUNTER CONTROLLER

XL1002J Digital Counter (24VDC POWER SUPPLY)

FEATURES:

Ultra-bright LED display
15.00mm digit height
Low cost
High accuracy
Easy to install, snap-in/mount in panel
Ideal for auto, boat, industrial, commercial & domestic uses

OPERATION SPECIFICATIONS:

Power Source	24VDC 150 mA
Maximum Count	99999 (5 digits)
Count Frequency	≤ 2kHz
Accuracy	±0.2%+2digit
Zero clearing	Short terminal
Counter signal	3.5~5VDC square wave Or short signal terminal
Operating Temperature	0 to 55 °C
Storage Temperature	-10 to +80 °C
Humidity	20%-80%
Weight	300g
Dimension	W96 x H48 x D77mm
Panel cutout	90x45mm
Mounting Method	Snap-in

XL1002J Digital Counter (24VDC POWER SUPPLY)

FEATURES:

Ultra-bright LED display
15.00mm digit height
Low cost
High accuracy
Easy to install, snap-in/mount in panel
Ideal for auto, boat, industrial, commercial & domestic uses

OPERATION SPECIFICATIONS:

Power Source	24VDC 150 mA
Maximum Count	99999 (5 digits)
Count Frequency	≤ 2kHz
Accuracy	±0.2%+2digit
Zero clearing	Short terminal
Counter signal	3.5~5VDC square wave Or short signal terminal
Operating Temperature	0 to 55 °C
Storage Temperature	-10 to +80 °C
Humidity	20%-80%
Weight	300g
Dimension	W96 x H48 x D77mm
Panel cutout	90x45mm
Mounting Method	Snap-in

Terminal Connection Diagram

METER REAR

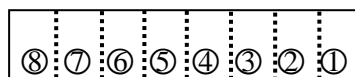

PIN 8 + 24V DC Positive, Power source
PIN 7 - 24V DC Negative, Power source
PIN 5 PIN 6 Relay Switch [Max pass 220VAC 1A]
PIN 4 RESET /Zero Clearing [Short PIN4, PIN2]
PIN 3 SETUP [Short PIN4, PIN2]
PIN 2 Common Ground
PIN 1 Counter add Signal input [or Short PIN 1, PIN2]

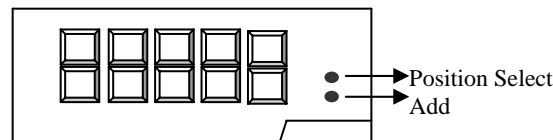

Upper Counting Limit SETUP:

Short Terminal PIN3,PIN2,

Login into setting status, the first '8' will flicker
Press 'ADD' button, change the limit value of the flickering '8'.
Press 'Position select', to change setting position
Short Terminal PIN3,PIN2, quit out setting status.

Terminal Connection Diagram

METER REAR



PIN 8 + 24V DC Positive, Power source
PIN 7 - 24V DC Negative, Power source
PIN 5 PIN 6 Relay Switch [Max pass 220VAC 1A]
PIN 4 RESET /Zero Clearing [Short PIN4, PIN2]
PIN 3 SETUP [Short PIN4, PIN2]
PIN 2 Common Ground
PIN 1 Counter add Signal input [or Short PIN 1, PIN2]

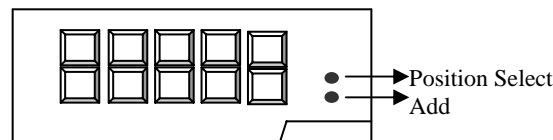

Upper Counting Limit SETUP:

Short Terminal PIN3,PIN2,

Login into setting status, the first '8' will flicker
Press 'ADD' button, change the limit value of the flickering '8'.
Press 'Position select', to change setting position
Short Terminal PIN3,PIN2, quit out setting status.