

Basic Troubleshooting

*LED not displayed

Check the power source is correct voltage (DC5V) and correct polarity.

*Display appears scrambled

Check that all connections are correct and tight.
Confirm no strong electromagnetic interference nearby.

*Caution

Do not disassemble

*Panel Cutout Size

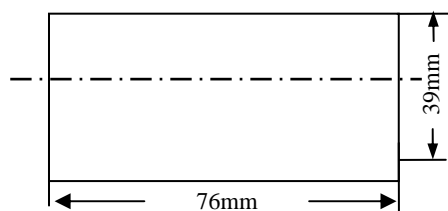

MANUAL

DIGITAL FREQUENCY METER

XIELI

ISO9001-2008 & CE

Shaanxi XIELI Photo Electric Instrument Co., Ltd

Add: No.2 Xinke Rd, Xi'an 710043, Shaanxi, CHINA

Tel: +86-29-82622375 Fax: +86-29-84023638

www.xieli-china.com

XL5155P Series Digital Frequency Meter

Digital Frequency Meter - Power Source DC5V

FEATURES:

Ultra-bright LED display
15.00mm digital height
Blue/Red displays available
Low cost high accuracy
Easy to install

OPERATION SPECIFICATIONS:

Power Supply	DC5V
Maximum Count	99999(5 digitals)
Accuracy	±0.02%+3 digit
Waveform	Square wave 3-10V Sine wave 3-250V
Operating temperature	0°C~60°C
Storage Temperature	-20°C~80°C
Relative humidity	20%~80%
Dimension	W79mm x H42.5mm x D40.0mm
Panel Cutout	76mm×39mm

CONNECTION DIAGRAM:

View of PINs with screen facing upwards.

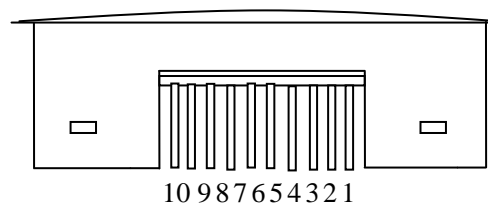

PIN 1	Hi-voltage signal inputting
PIN 2	Lo-voltage signal inputting
PIN 3-8	Blank
PIN 9	DC5V- Cathodes
PIN 10	DC5V + Anode

Notice:

*Keep far way strong electromagnetic interference source, if it is impossible, please use shielding signal cable or twisted-pair cable
*Please turn on the power then give signal to meter when you start the meter, and cut off the signal inputting then turn off the power when you stop the working.

Model	Range	Resolution	Accuracy	Over Range Display
XL5155P-2	0.10~99.99Hz	0.02Hz	± 0.02%+2digit	UUUUU
XL5155P-3	100.1~950.0Hz	0.2Hz	± 0.02%+2digit	FUUUU
XL5155P-4	0~99.999kHz	1Hz	± 0.02%+2digit	UUUU